



## Main Features

- 10.1" TFT color display, LED backlight
- 1024 x 600 pixel (WSVGA) resolution, 16.7M colors
- Resistive touchscreen
- 2 x Giga LAN and 2 x USB 3.0
- 1 x RS232/422/485 communication port
- Extremely cost efficient HMI with plastic chassis
- Slim design, mounting depth less than 30mm
- System frame ground protection (GPE) design

## Product Overview

The eLITE610 is Intel Atom x5-E3930 high performance HMI with the JMobile software offers full vector graphic capabilities and plenty of connectivity options. The eLITE610 features a bright 10.1" TFT widescreen (16:9) display with 2 Giga LAN and 2 USB 3.0.

### Highlight

- JMobile runtime included. Full compatibility with JMobile Studio
- Full vector graphic support. Native support of SVG graphic objects. Transparency and alpha blending
- Multilanguage applications. Easily create and manage your applications in multiple languages to meet global requirements. Far east languages are supported. Tools available in JMobile studio support easy third-party translations and help reducing development and maintenance costs of the application
- Data display in numerical, text, bargraph, analog gauges and graphic image formats
- Rich set of state-of-the-art HMI features: data acquisition, alarm handling, scheduler and timed actions (daily and weekly schedulers, exception dates), recipes, users and passwords, e-mail and RSS feeds, rotating menus
- Includes support for a wide range of communication drivers for factory and building automation systems
- Multiple drivers communication capability
- Remote monitoring and control. Client- server functionality. Mobile clients supported
- Remote maintenance and support with VNC-based functionality
- Off-line simulation of the HMI application with JMobile studio
- Powerful scripting language for automating HMI applications. Script debugging improves efficiency in application development
- Rich gallery of symbols and objects
- Project templates
- Optional plug-in modules for fieldbus systems, I/O and controllers
- Display backlight dimmable to 0%

## Specifications

Technical Data	eLITE610	Technical Data	eLITE610
Panel	<ul style="list-style-type: none"> <li>- 10.1", 16:9, WSVGA, 1024 x 600</li> <li>- Luminance: 240 cd/m<sup>2</sup> typ.</li> <li>- LCD color: 16.7M</li> <li>- Active display area: 10.1" diagonal</li> <li>- Backlight: LED</li> </ul>	Ratings	<ul style="list-style-type: none"> <li>- Power supply voltage: 24 Vdc (19.2 to 28.8 Vdc)</li> <li>- Current consumption: 1.64A at 24Vdc (max.)</li> <li>- Weight: Approx. 1.37Kg</li> </ul>

## Dimension Drawing

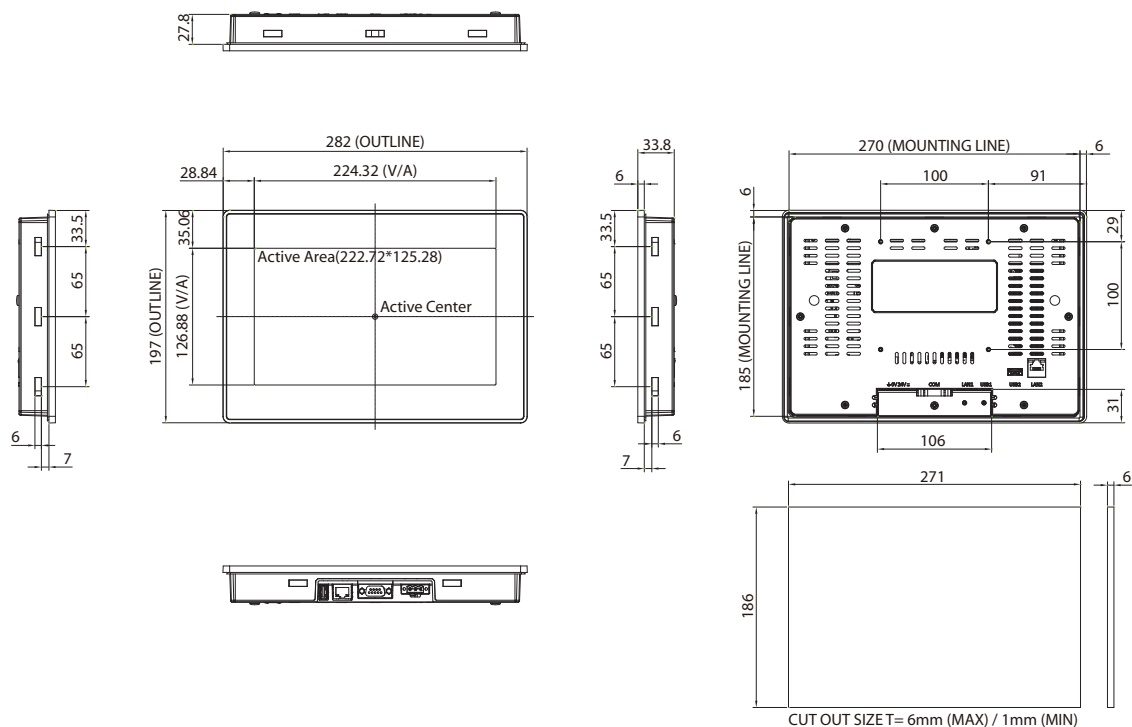

Technical Data	eLITE610	Technical Data	eLITE610
Operator Interface	- Touch: resistive	Environmental Conditions	- Operating temperature: -5°C to 50°C - Storage temperature: -20°C to 75°C - Operating and storage humidity: 5%~90% relative humidity, noncondensing - Panel/VESA mounting - Protection class: IP66 (front), IP20 (rear)
System Resources	- CPU: Intel® Atom™ x5-E3930 processor - Operating System: Windows 10 Enterprise (64-bit) - RAM: 4GB DDR3L - Flash: 32 GB - Real time clock: Yes - Buzzer: Yes	Dimensions	- Faceplate LxH: 282 x 197mm - Cutout AxH: 271 x 186mm - Depth D+T: 29 + 6mm
Interface	- Ethernet: 2x 10/100/1000Mbit - USB: 2 x USB3.0 - Serial: 1 x RS232/422/485 BIOS configuration	Certifications	- CE (Emission EN61000-6-4; Immunity EN61000-6-2 for installation in industrial environments) - FCC

## Ordering Information

### Barebone

#### ♦ eLITE610 (P/N: 10IE0061000X0)

10.1" widescreen WXGA with Intel® Atom™ x5-E3930, Ethernet and USB 3.0 interfaces, JMobile run-time